

INSTALLATION INSTRUCTIONS



TUNABLE LED RIGID LINEAR FIXTURE

SG250-08-SWC-WH/ SG250-12-SWC-WH/ SG250-24-SWC-WH/ SG250-36-SWC-WH/ SG250-48-SWC-WH/ SG250-60-SWC-WH

BEFORE YOU START:

- Please check local electrical codes before beginning
- Turn power off before installing
- Make sure to use properly rated wire

Power Cord

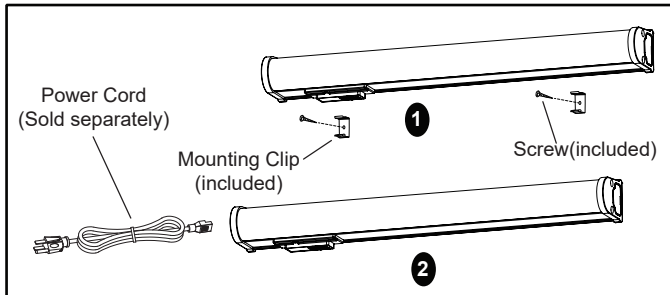

Linking

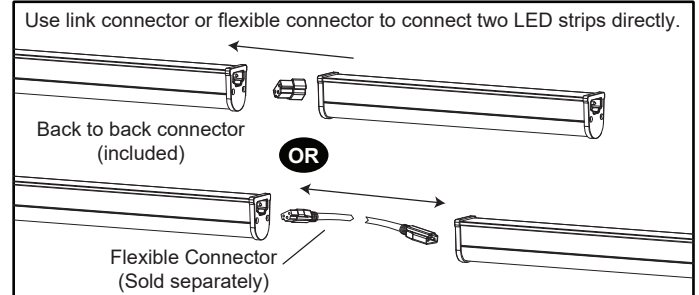

Note: The maximum number of fixtures that can be interconnected with either flexible wire connectors or link connectors is 10.

Hardwire

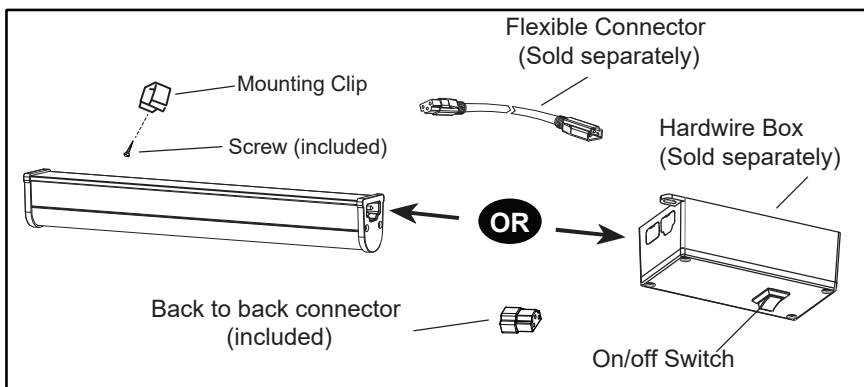

Parts Included

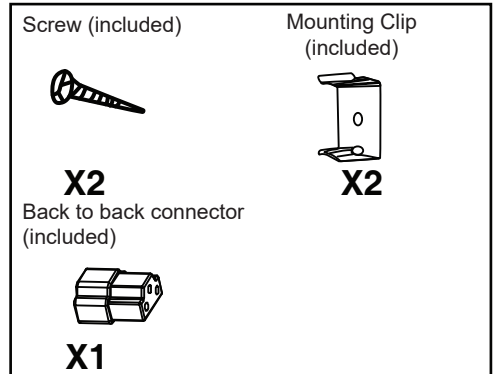

WIRING A DIMMER

